

EA-A06 USB Controller

Electronic access

Features

- Allows computer controlled electromechanical latch operation via USB port
- 14 independent latch inputs / outputs
- Simple programming commands / easy program interface
- Integrate with any Southco electromechanical latch solution
- Labeled connections for easy set up



Product Performance

- Operating voltage: 12 - 24 VDC
- Do not exceed max latch voltage
- Max output per latch: 2 amps

Controller Assembly

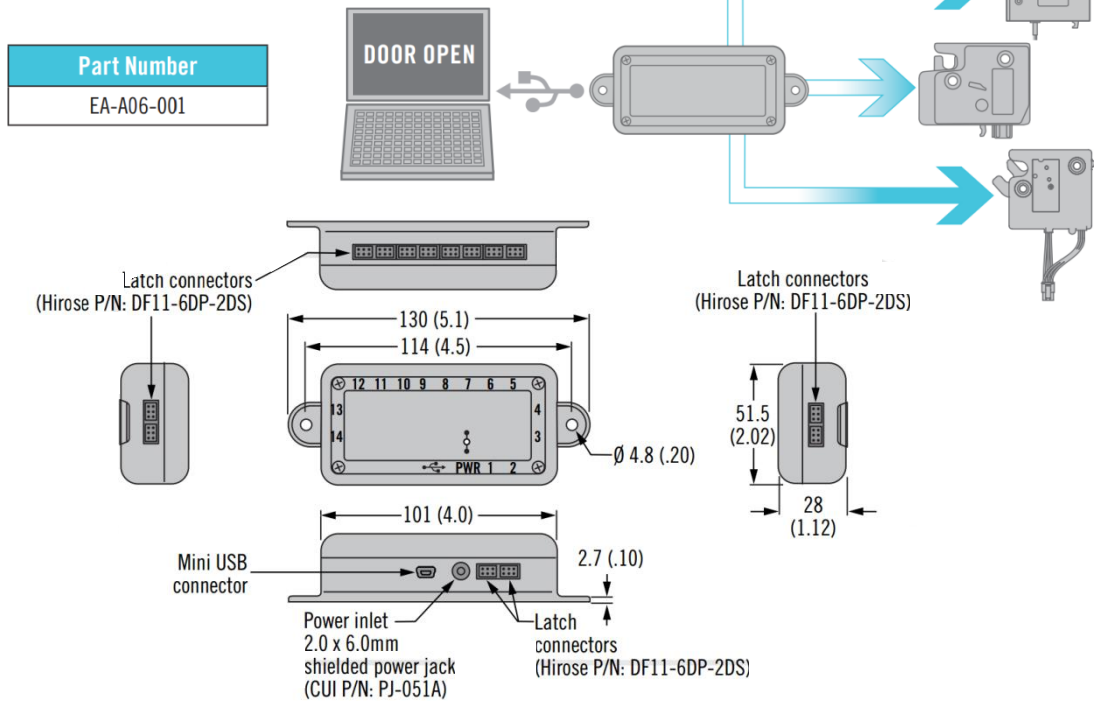

1 Meter USB Cable (Included)



EA-A02-002 Power Supply
(Order separately)



Wire Harness Options		
Part Number	Length	Connects to
EA-W01-200*	2 Meters	Stripped and Tinned
EA-W20-201-01*	2 Meters	
EA-W20-201-01*	2 Meters	
EA-W01-200-01*	2 Meters	
EA-W02-203-01*	2 Meters	

*Contact Gripwell Sales for custom lengths

Power Plug Adapters

Part Number	Description	Function
EA-A02-002**	Power Supply with NA 2-Pin	
EA-A02-002 & EA-A02-002-2	Power Supply with Euro 2-Pin	
EA-A02-002 & EA-A02-002-3	Power Supply with UK 3 Pin	
EA-A02-002 & EA-A02-002-4	Power supply with SAA 2-Pin	

**EA-A02-002-1 NA 2-PIN included with EA-A02-002 Power Supply.

We are proud to be Southco's authorized distributor of over 20 years